

RSRS Series Straight-Body Steel Cord Grips

The Tuff-Seal RSRS series of cord grips features a body and compression nut made of plated steel for added strength and durability, enhanced resistance to rust and a better physical appearance. These grips can be ordered with or without wire mesh attachments and accommodate 3/8" through 1" conduit. The design of the nut in these cord grips is a hexagon for part of the length and round with a knurl for the remainder of the length.

RSRS Steel & RSSS Stainless Steel Cord Grips Only Dimension Table

Catalog Number*	Conduit Size	A Body Bore	B	C	D	E Body Hex.	F Nut Dia.	Form Size
RSRS-000-W	3/8"	.47	.44	.56	1.47	.88	.88	1
RSRS-100-W	1/2"	.62	.56	.69	1.81	1.00	.12	2
RSRS-200-W	3/4"	.81	.56	.85	2.05	1.25	.37	3
RSRS-300-W	1"	1.00	.63	.94	2.29	1.43	.56	4
RSSS-000-W	3/8"	.47	.44	.56	1.47	.88	.88	1
RSSS-100-W	1/2"	.62	.56	.69	1.81	1.00	.12	2
RSSS-200-W	3/4"	.81	.56	.85	2.05	1.25	.37	3

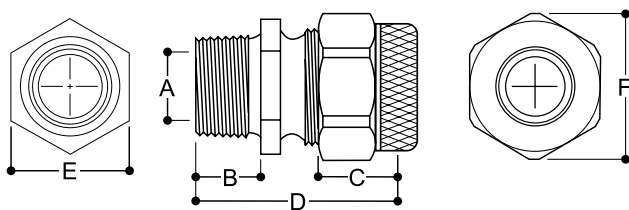

RSSS Series Stainless Steel Cord Grips

The Tuff-Seal RSSS series of cord grips features a body and compression nut made of stainless steel which provides the highest levels of durability in severely corrosive environments filled with saltwater, acids or chemicals. These grips can be ordered with or without wire mesh attachments and accommodate 3/8" through 3/4" conduit.

RSRS Series

Conduit Size	Cable Range	Complete Assembly Catalog Numbers		
		Cord Grip Only	Cord Grip With Mesh	
3/8"	.125-.188	RSRS-003	—	
	.188-.250	RSRS-004	RSRS-004-E	
	.250-.312	RSRS-005	RSRS-005-E	
	.312-.375	RSRS-006	RSRS-006-E	
	.375-.438	RSRS-007	RSRS-007-E	
1/2"	.125-.188	RSRS-103	—	
	.188-.250	RSRS-104	RSRS-104-E	
	.250-.312	RSRS-105	RSRS-105-E	
	.312-.375	RSRS-106	RSRS-106-E	
	.375-.438	RSRS-107	RSRS-107-E	
	.438-.500	RSRS-108	RSRS-108-E	
	.500-.562	RSRS-109	RSRS-109-E	
	.562-.625	RSRS-110	RSRS-110-E	
	3/4"	.438-.500	RSRS-208	RSRS-208-E
		.438-.562	RSRS-209	RSRS-209-E
.500-.625		RSRS-210	RSRS-210-E	
.562-.688		RSRS-211	RSRS-211-E	
.625-.750		RSRS-212	RSRS-212-E	
.688-.812		RSRS-213*	RSRS-213-E	
1"		.438-.562	RSRS-309	RSRS-309-E
	.500-.625	RSRS-310	RSRS-310-E	
	.562-.688	RSRS-311	RSRS-311-E	
	.625-.750	RSRS-312	RSRS-312-E	
	.688-.812	RSRS-313	RSRS-313-E	
	.750-.875	RSRS-314	RSRS-314-E	
	.812-.938	RSRS-315	RSRS-315-E	
	.875-1.000	RSRS-316	RSRS-316-E	

RSSS Series

3/8"	.125-.188	RSSS-003	—	
	.188-.250	RSSS-004	RSSS-004-E	
	.250-.312	RSSS-005	RSSS-005-E	
	.312-.375	RSSS-006	RSSS-006-E	
	.375-.438	RSSS-007	RSSS-007-E	
1/2"	.125-.188	RSSS-103	—	
	.188-.250	RSSS-104	RSSS-104-E	
	.250-.312	RSSS-105	RSSS-105-E	
	.312-.375	RSSS-106	RSSS-106-E	
	.375-.438	RSSS-107	RSSS-107-E	
	.438-.500	RSSS-108	RSSS-108-E	
	.500-.562	RSSS-109	RSSS-109-E	
	.562-.625	RSSS-110*	RSSS-110-E	
	3/4"	.438-.500	RSSS-208	RSSS-208-E
		.438-.562	RSSS-209	RSSS-209-E
.500-.625		RSSS-210	RSSS-210-E	
.562-.688		RSSS-211	RSSS-211-E	
.625-.750		RSSS-212	RSSS-212-E	
.688-.812		RSSS-213*	RSSS-213-E	

Larger sizes are available. Consult factory.